

ASTON CAMLI DOLAP GÖVDE

ASTON GLASS CABINET BODY

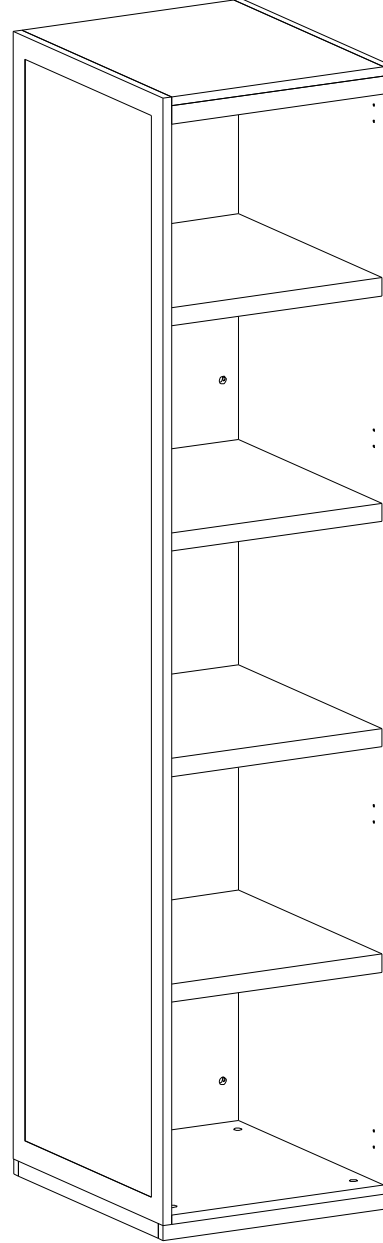

Assembly Instruction

Page 1/7

Sayın Müşteri,
Satın almış olduğunuz bu ürün size ulaşmadan önce tüm test edilmiş, kontrol edilmiş ve paketlenmiştir. Ancak nakliye sırasında bazı parçalar zarar görebilir. Böyle bir durumla karşılaşırsanız ürünün tamamını geri göndermeyin. ve sadece hasarlı parçayı ve malzemeyi isteyin.

Gerekli parça ve malzemelerin kodunu kurulumda bulabilirsiniz.
Manuel.
Montaja başlamadan önce kolilerden çıkan ürünler eksiksizdir. ve zararsız, olduğundan emin olun.
Birden fazla ürün satın aldıysanız montajı tamamlamadan tek bir ürünü, bitirmeden ikinci ürünü açarak karışıklık yaratmayınız. Kurulumu başlamadan önce her parçayı hafif nemli bir bezle silin ve kurulumu başlatın,
Başlayabilirsiniz.
Lütfen mobilyalarınızı amacı dışında kullanmayınız.

Dear Customer,
Before this product you have purchased reaches you, all of our has been tested and checked and packaged.
However, some parts may be damaged during transportation.
If you encounter such a situation, do not send the entire product back. and simply ask for the damaged part and the material.

You can find the code of the required parts and materials in the installation manual.
Before starting the assembly, the products coming out of the boxes are complete and harmless make sure it is.
If you have purchased more than one product, without completing the assembly of a single product,
Do not cause confusion by opening the second product.
Before starting the installation, wipe each part with a slightly damp cloth and start the installation.
You can start.
Please do not use your furniture for other than its intended purpose.

PARÇA KODU	PARÇA ADI	ADET
PK-1	ALT TABLA / BOTTOM TABLE	1
PK-1	CAMLI BLOK LEDLİ RAF / GLASSED BLOCK LED SHELF	4
PK-1	ÜST TABLA / TOP TABLE	1
PK-1	MALZEME PAKETİ / MATERIAL PACKAGE	1
PK-1	METAL LED PROFİL / METAL LED PROFILE	1
PK-2	ARKA PANO / BACK PANEL	1
PK-2	CAMLI YAN TABLA / GLAZED SIDE TABLE	1
PK-2	YAN TABLA / SIDE TABLE	1

In case you need a sparepart, please indicate "Model Code" and "Accessory Code" shown in the assembly instructions.

LET'S PAY ATTENTION TO THE CODE AND LOCATION OF THE MATERIALS WHEN POSITIONING

ASTON CAMLI DOLAP GÖVDE ASTON GLASS CABINET BODY

PARTS THAT CAN BE SERVICED AFTER SALES SSH OLABİLECEK PARÇALAR

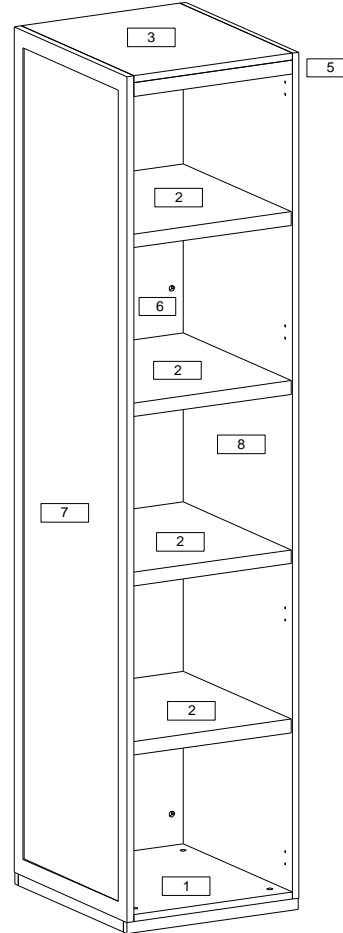

PARÇA KODU	PARÇA ADI	ADET
1	ALT TABLA / BOTTOM TABLE	1
2	CAMLI BLOK LEDLİ RAF / GLASSED BLOCK LED SHELF	4
3	ÜST TABLA / TOP TABLE	1
4	MALZEME PAKETİ / MATERIAL PACKAGE	1
5	METAL LED PROFİL / METAL LED PROFILE	1
6	ARKA PANO / BACK PANEL	1
7	CAMLI YAN TABLA / GLAZED SIDE TABLE	1
8	YAN TABLA / SIDE TABLE	1

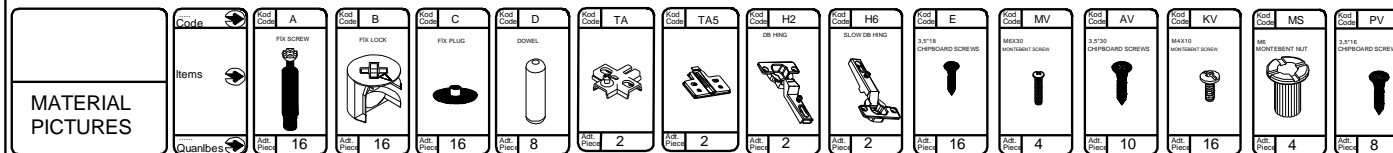

In case you need a sparepart, please indicate "Model Code" and "Accessory Code" shown in the assembly instructions.
LET'S PAY ATTENTION TO THE CODE AND LOCATION OF THE MATERIALS WHEN POSITIONING

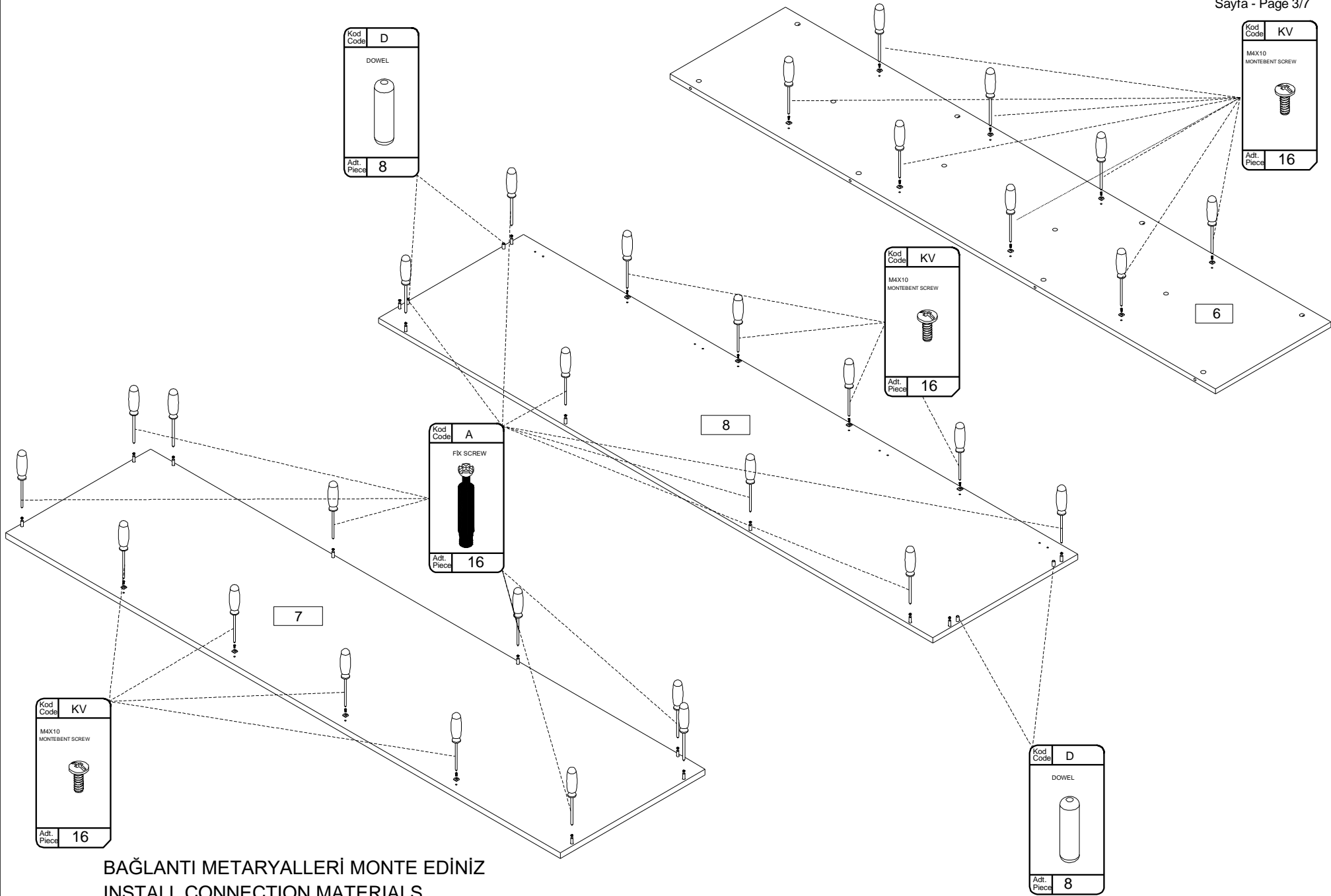

BAĞLANTI METARYALLERİ MONTE EDİNİZ
 INSTALL CONNECTION MATERIALS

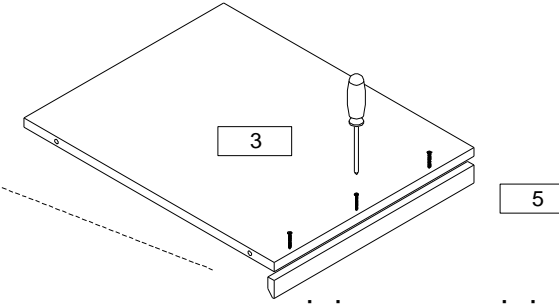
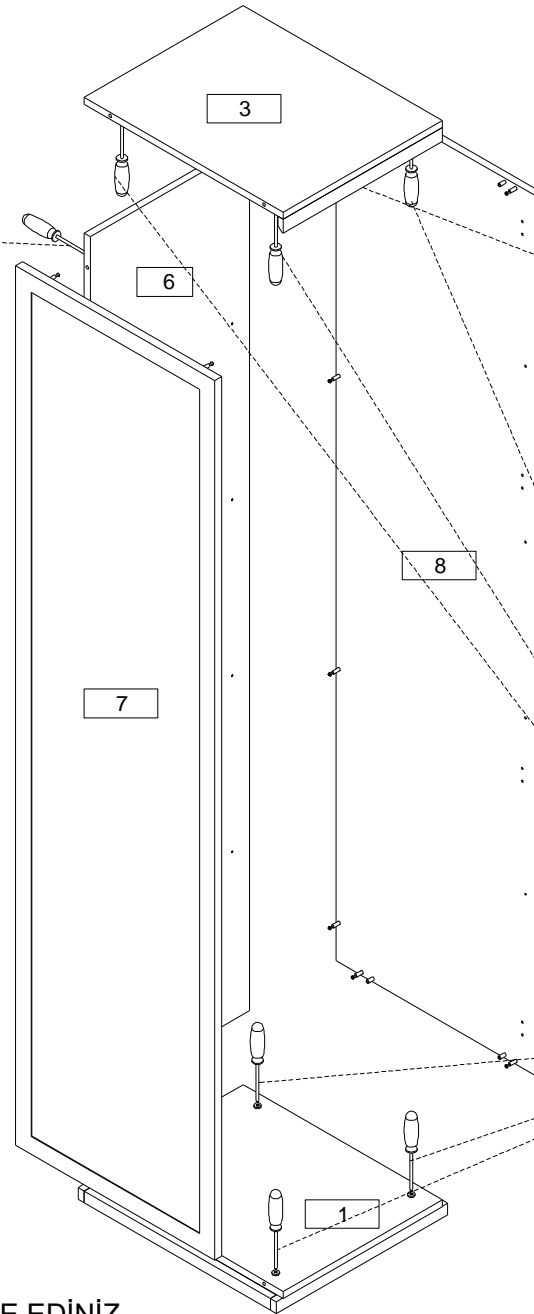
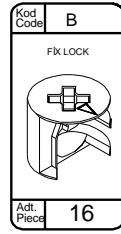

LED METALİNİ MONTE EDİNİZ
INSTALL THE LED METAL

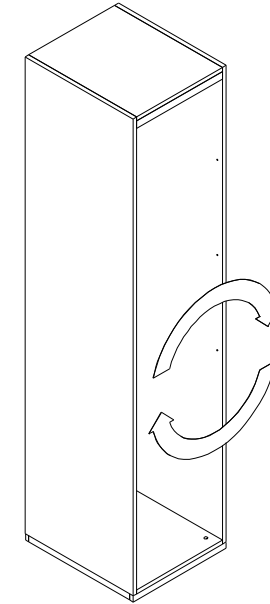

YAN TABLALARIN YERİNİ DEĞİŞTİREREK
SAĞ VEYA SAĞ MODÜL YAPABİLİRSİNİZ

YOU CAN MAKE A RIGHT OR RIGHT
MODULE BY CHANGING THE LOCATIONS
OF THE SIDE TABLES

BAĞLANTI METARYALLERİ MONTE EDİNİZ
INSTALL CONNECTION MATERIALS

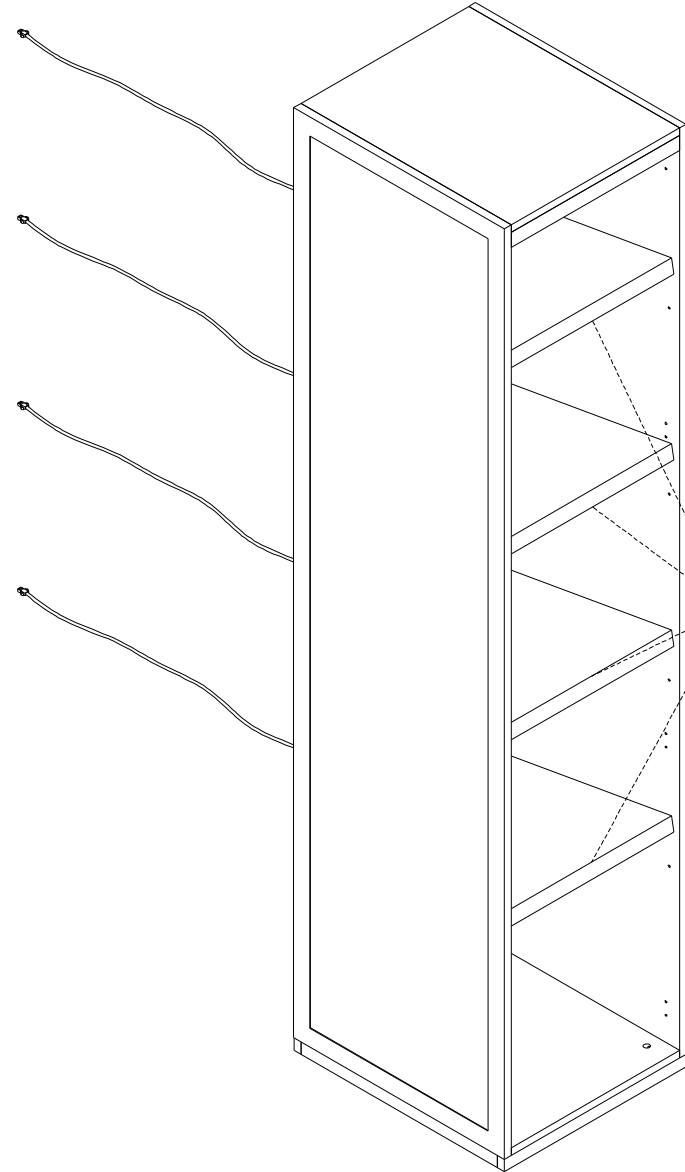

AÇILI ŞEKİLDE TAKINIZ
INSTALL IT AT AN ANGLE

BAĞLANTI METARYALLERİ MONTE EDİNİZ
INSTALL CONNECTION MATERIALS

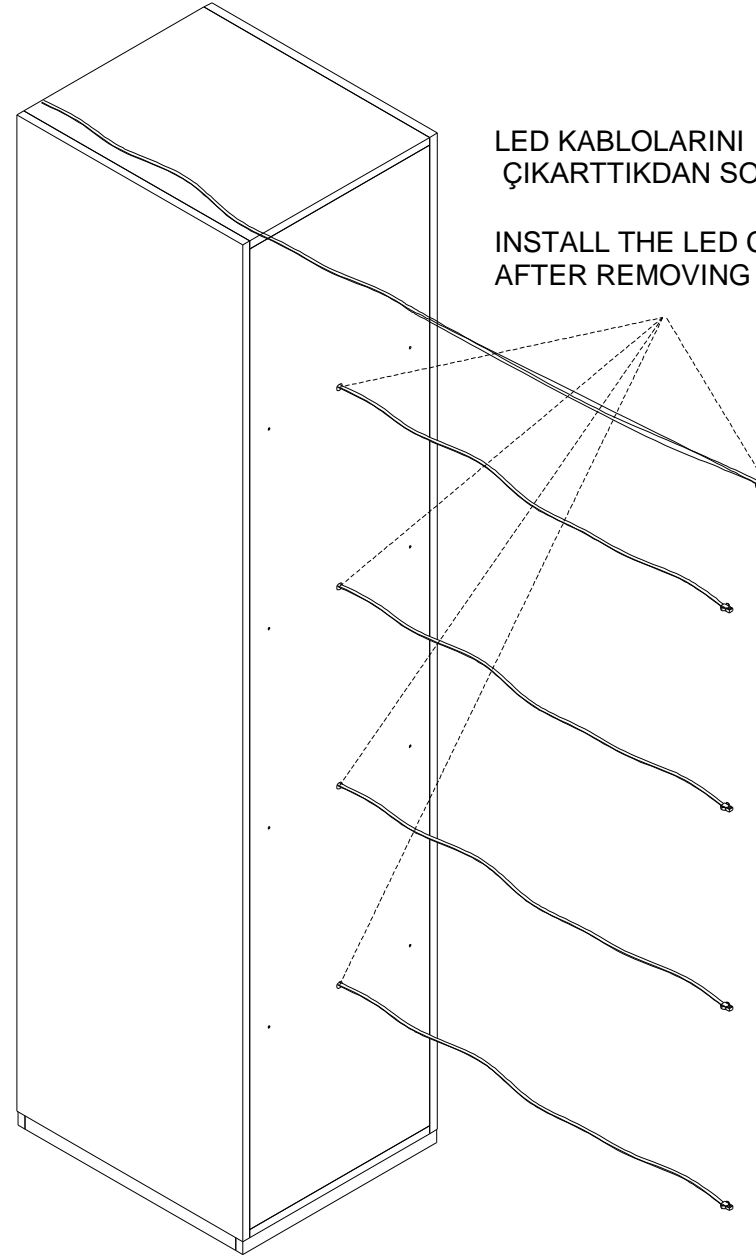

LED KABLolarINI
ÇIKARTTIKDAN SONRA TAKINIZ

INSTALL THE LED CABLES
AFTER REMOVING THEM

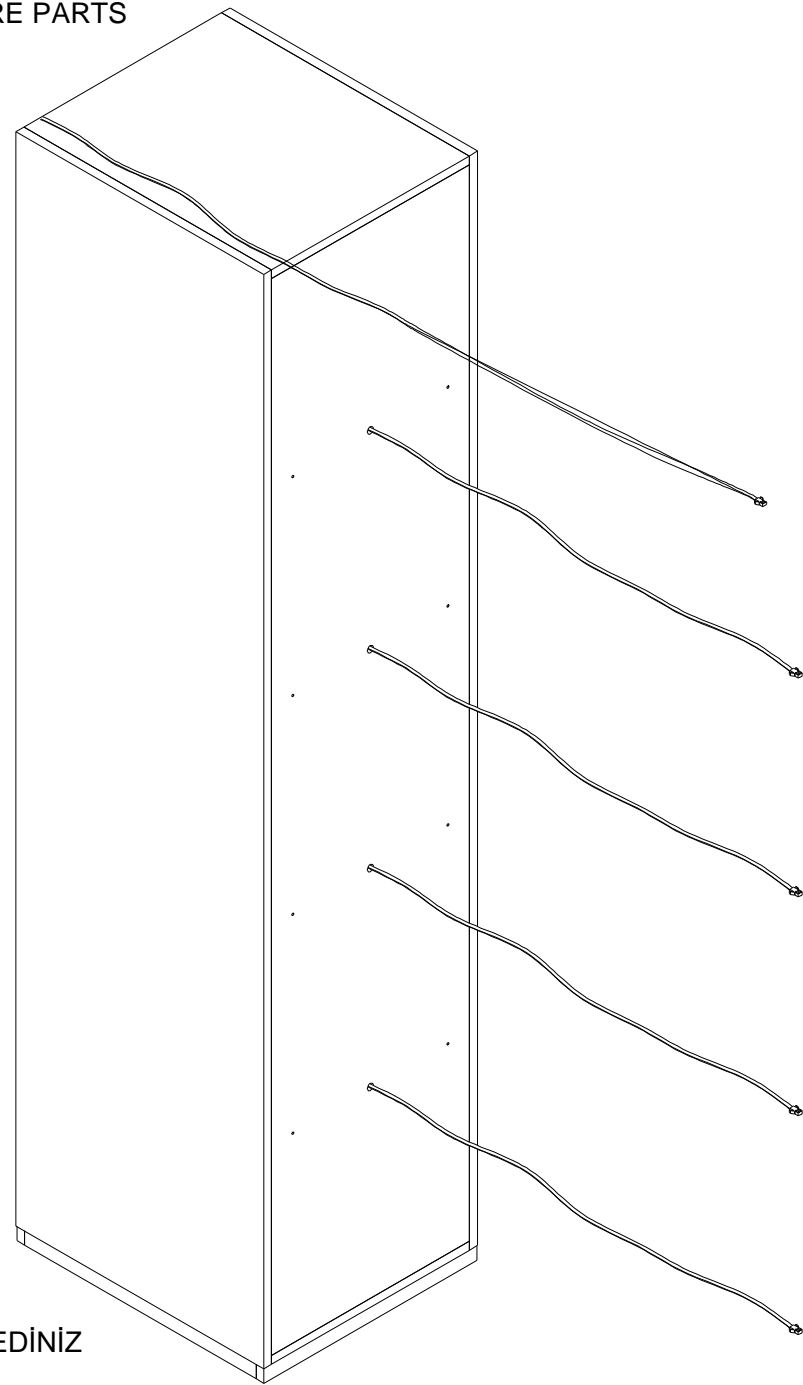

LED KABLORINI
TOPLAYICIYA TAKINIZ

INSTALL LED CABLES
TO THE COLLECTOR

BAĞLANTI METARYALLERİ MONTE EDİNİZ
INSTALL CONNECTION MATERIALS

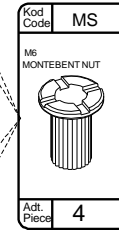
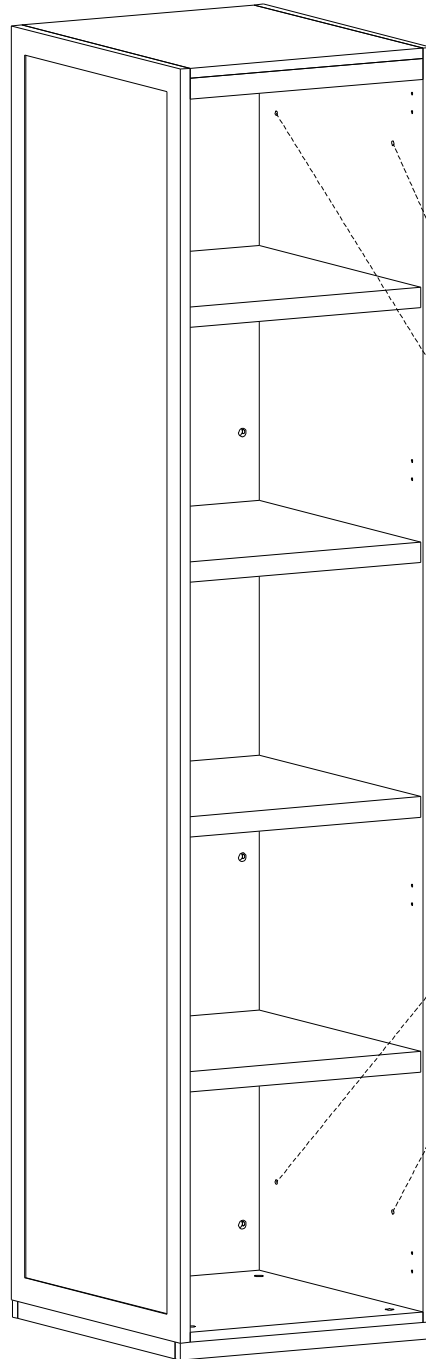

DİĞER MODÜLLERİ BİRLEŞTİRMEK
İÇİN İÇTEN MONTAJ

INSTALL FROM THE INTERIOR TO
COMBINE OTHER MODULES

BAĞLANTI METARYALLERİ MONTE EDİNİZ
INSTALL CONNECTION MATERIALS